

REVISIONS	BY
5/29/01	

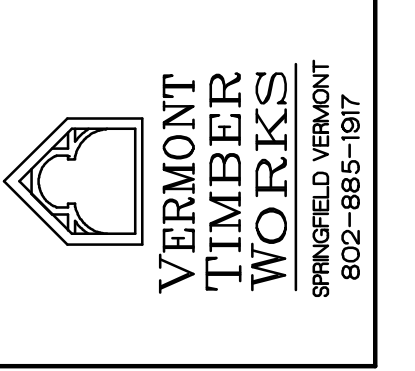

SHOP DRAWINGS

PROJECT: Our Lady of the Mountains
North Conway, New Hampshire

DRAWN : D.F.	CHECKED :
DATE : 5/4/01	
SCALE : 1/4" = 1'-0"	
JOB NO. :	
SHEET	
F-1	
OF	SHEETS

General Notes:
Timbers to be Douglas Fir #1 & Better FOHC S4S
Pegs to be 1" Oak.
All edges to have 1/2" chamfer or as noted
One coat of sealer to be shop applied
on all sides.
All Bolts to be 3/4" zinc coated.

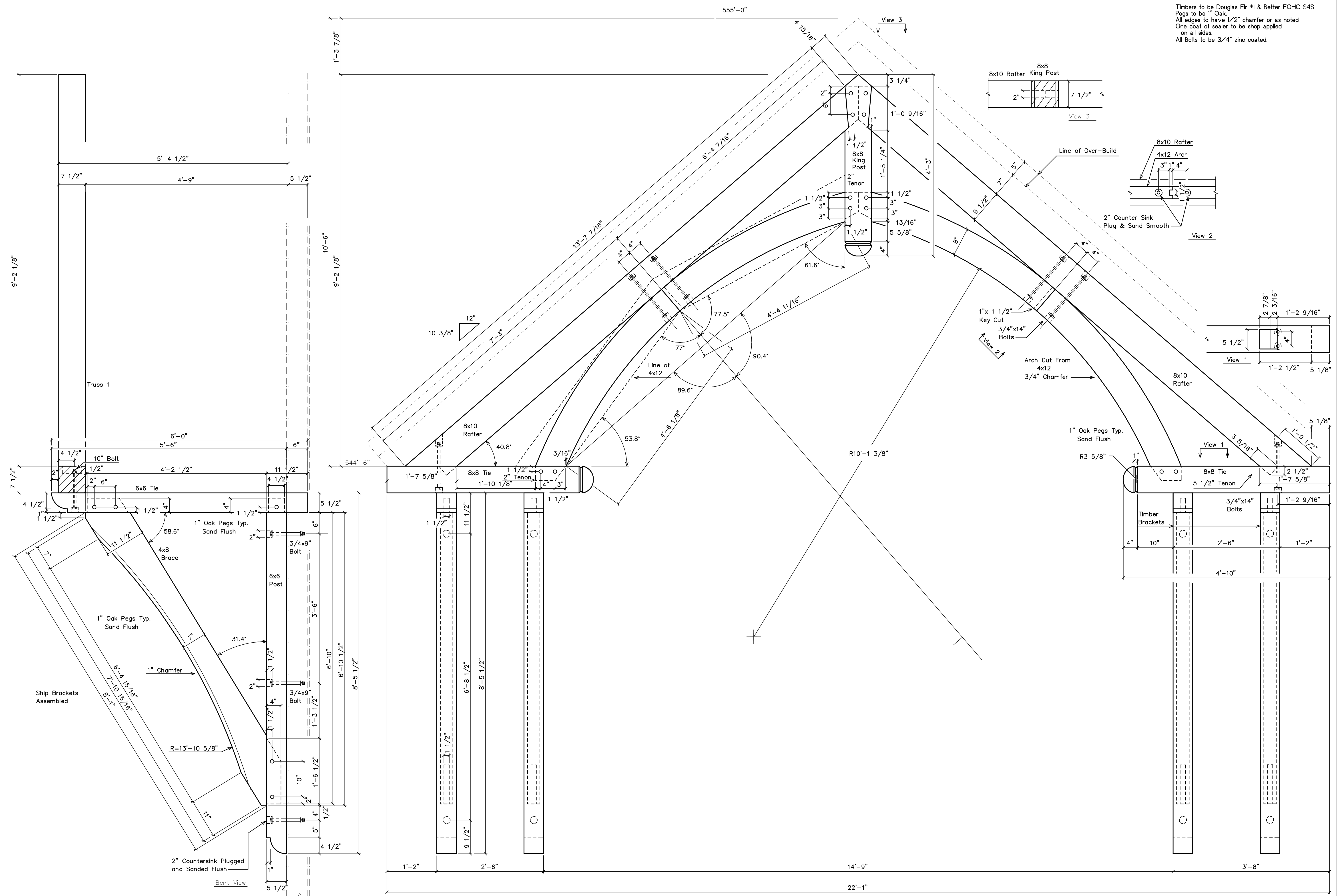

1 Canopy Bracket at Entry
F-1 From Detail 2/A-8 - 4 Braces Required

2 Truss 1 at Entry Canopy
F-1 1 Required