

Second Floor Framing

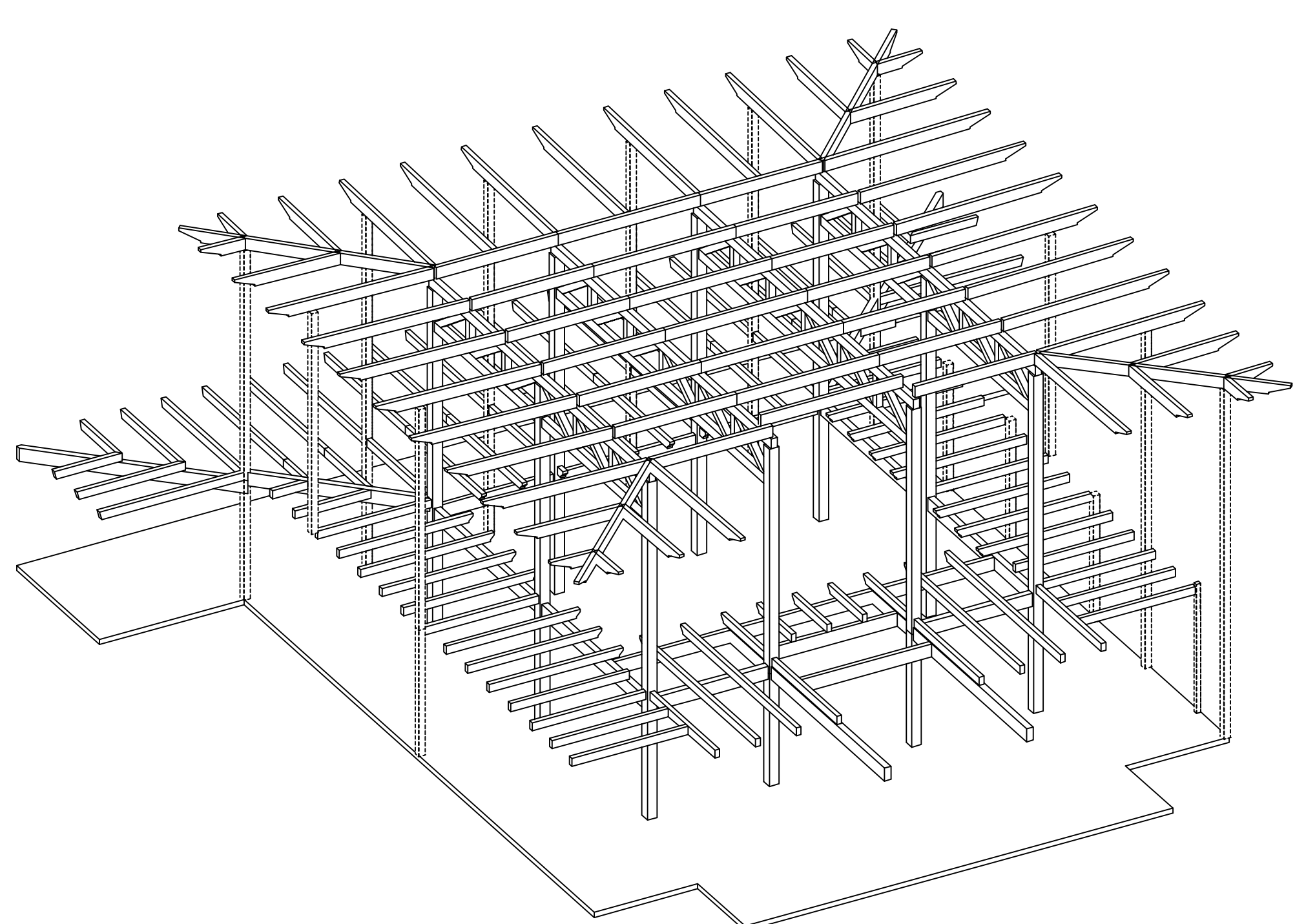

REVISIONS	BY
2/3/03	
2/14/03	
3/20/03	
3/31/03	
4/15/03	

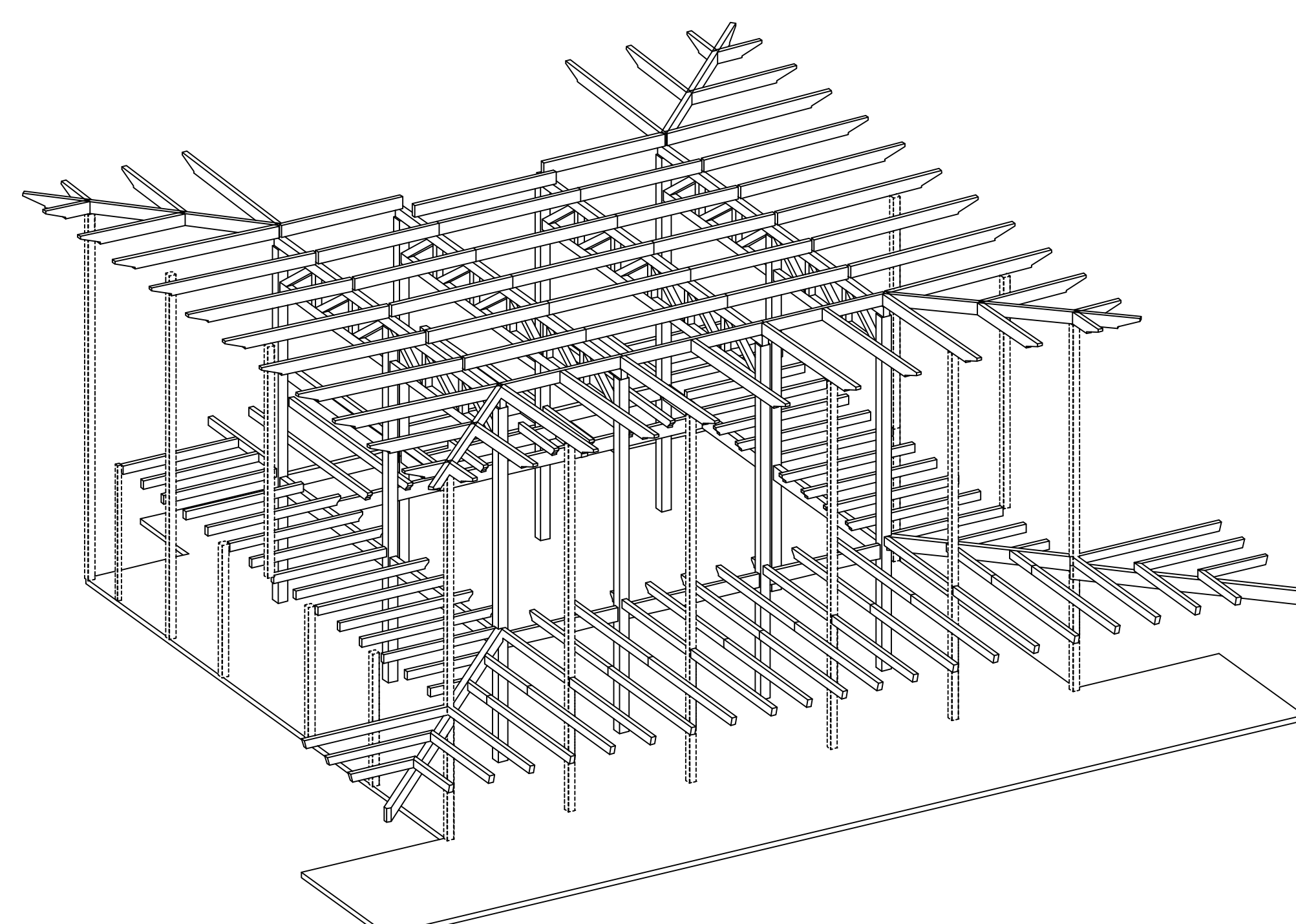
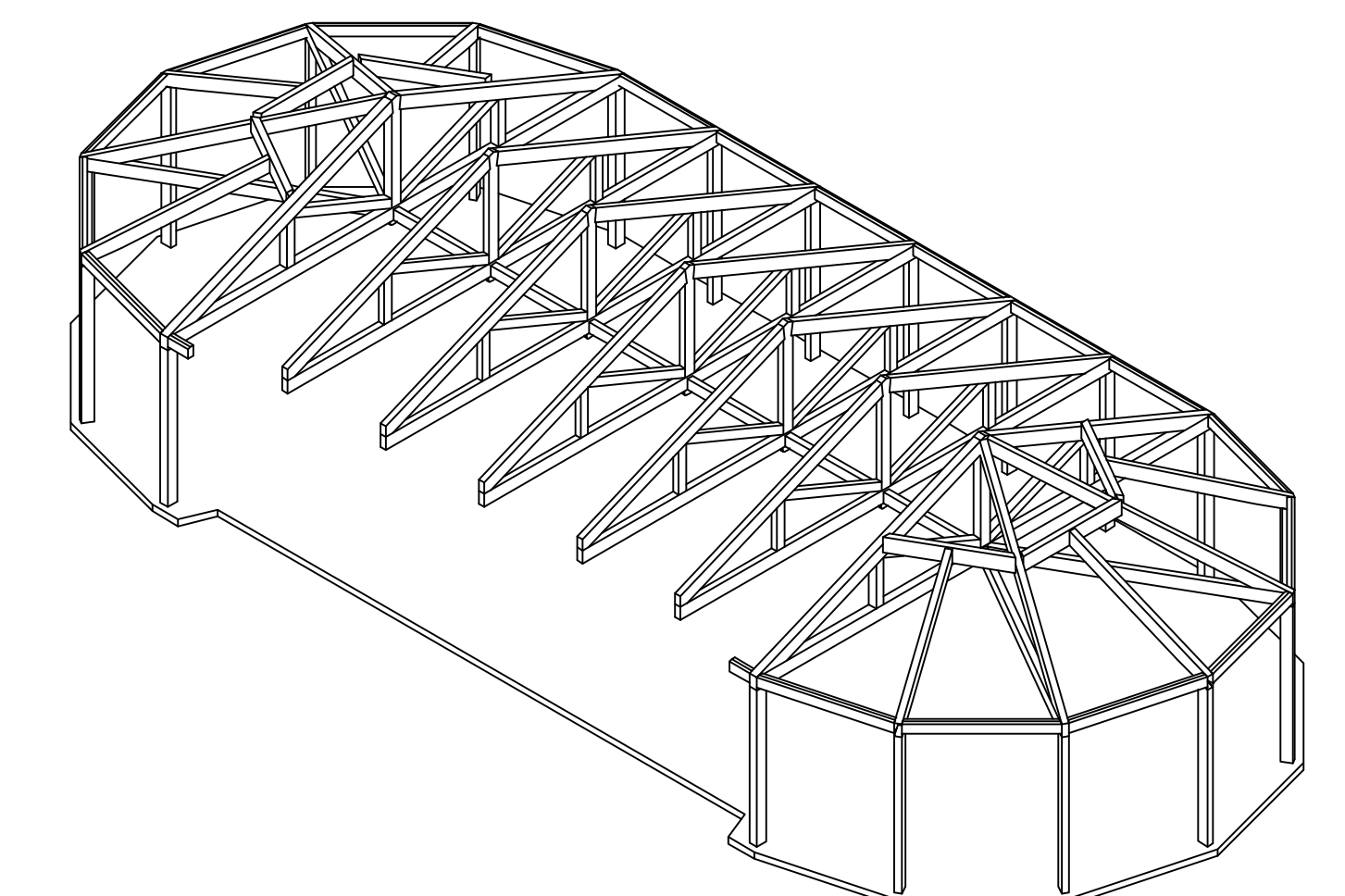
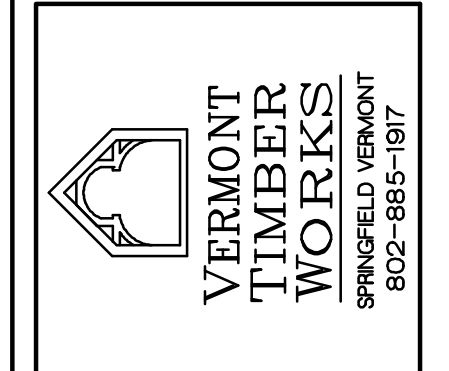

SHOP DRAWINGS  
Floor Framing  
Perspectives

PROJECT: Centennial Senior Center  
Timber Frame  
Concord, New Hampshire

DRAWN : D.F.  
CHECKED :  
DATE : 12/20/02  
SCALE : 3/16" = 1'-0"  
JOB NO. :  
SHEET

F-1  
OF SHEETS

General Notes:  
Timbers to be Douglas Fir #1 & Better S4S  
Pigs to be 7" thick  
All edges to have 1/2" chamfer  
One coat of stain, oil or urethane to be shop applied on all sides.  
All Bolts to be 3/4" for noted galvanized.  
All Steel to be galvanized.